

EZ OpenCap

EZ OpenCap enables easy opening and removal of 8/12 continuous tube lids, thereby preventing liquid intersect contamination. Allows easy manipulation and can collocate with 96-well plate frame. Stainless material enables repeated disinfection by autoclaving. Fillister in the handgrip has been specifically designed to be used as a lid press implement. Can be suspended at the bench for easy access.

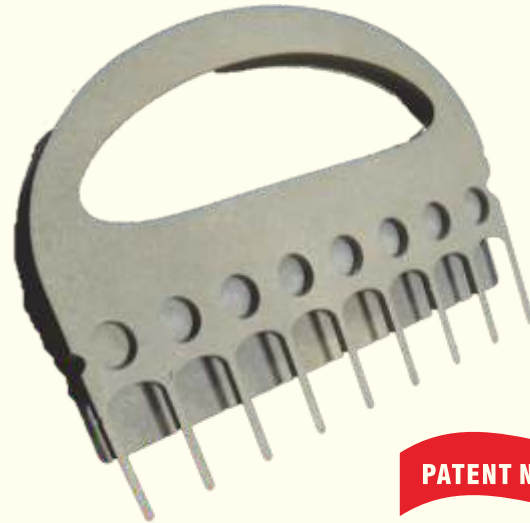

PATENT NO.M494031

Opening the strips

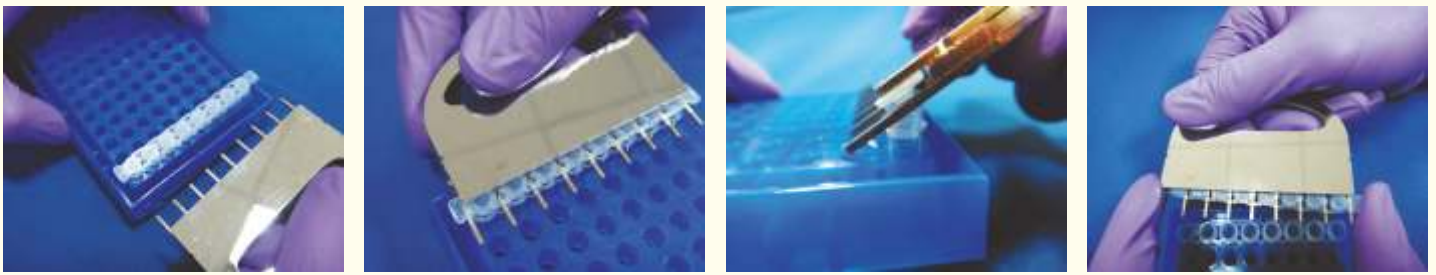

Insert the front of the EZ OpenCap (the needle head pattern) into the gap of 8/12 continuous lid. And gently press down to open the tube lid. No contamination when you use EZ OpenCap.

Closing the strips



The handgrip can be used as a lid press implement to put the lids in the tubes.

- ◆ Fits perfectly for opening caps of standard size PCR strip tubes.
- ◆ Allows easy and gentle opening of strip tubes.
- ◆ Prevents finger pain.
- ◆ Works with strips of 8 and 12 tubes.
- ◆ No exchange of aerosol between tubes.
- ◆ No force required, No breakage of strip caps, No pain in fingers.

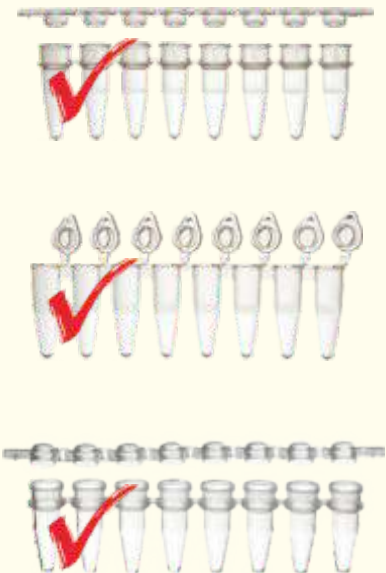

Cat No	specification
9100-000	EZ OpenCap